

 **HOLZTEC**
GERMAN CRAFTED WINDOWS AND DOORS

TECHNICAL SPECIFICATIONS



WOOD

There are 3 laminated layers of compressed Meranti wood imported from Germany. The refilling of the wood laminated is section 86 X 72 mm. The density ranges from 450 to 600 kg/m³ and the humidity is 12 +/- 2.

SYSTEM

According to the German Industrial Association standards, DIN. 68 121/IV68.

SIDES

Outer frame is 80/66 mm and the leaves made of wood with profile 80/66 mm.

RAIN RAIL PROTECTION

Aluminium rails are used to protect the wood from rain and water. These stripes of aluminium are covered from both sides with plastic covers to prevent water and air leakage.

PAINT SPECIFICATIONS

The paints are imported from Remmers, a German company that abides by the international standards. The wood is painted with three coats with special water based paints. Our paint is waterborne paint for the priming of windows and doors. The first coat (basic) used is to treat the wood and protect it from insects and bugs. The second coat (filler) in this phase is used to paint the wood with filling colour to fill all the holes and protect the wood from water leaking. The final coat (colour) in this phase is used to paint the wood which gives the wood the designed colour according to the customer's need.

GLASS SPECIFICATIONS

Insulating double glass sealed by silicon on both sides, we offer the most up to date and the highest grade of glass from Dr Greiche.

The sound absorption is up to the third degrees {35 decibel} according to the German Industrial Association standards DIN. 68 121/IV68

HARDWARE & FITTING

Holztec hardware system is designed to bring back the era that celebrate the balance between extraordinary taste & functionality. Our Roto and Siegenia German hardware systems brands are made out of steel and for highly stressed hinges out of steel with quality. Holztec's line of hardware which is forged, hammered, milled, & finished with International German Standards, is available in various shapes and colours to satisfy all customers' needs.

SILICON SPECIFICATIONS

The Silicon used is particularly suitable for the sealing of windows, connecting joints and other movement joints. It offers long-term, good adhesion to most non-porous surfaces such as coated or glazed wood, glass and glazed surfaces. It is available in a wide range of colours.

RUBBER SPECIFICATIONS

The rubber used is the all-rounder amongst the sealing profiles. It guarantees optimum sealing tightness and there are stabilisation lips that strengthen the position. Moreover, it has an optimum head width that provides a greater tolerance range. It also has a hollow chamber lip profile for clearly visible deflection recovery of the seal, in addition to the fact that it is environmentally friendly.

WINDOW SECTION

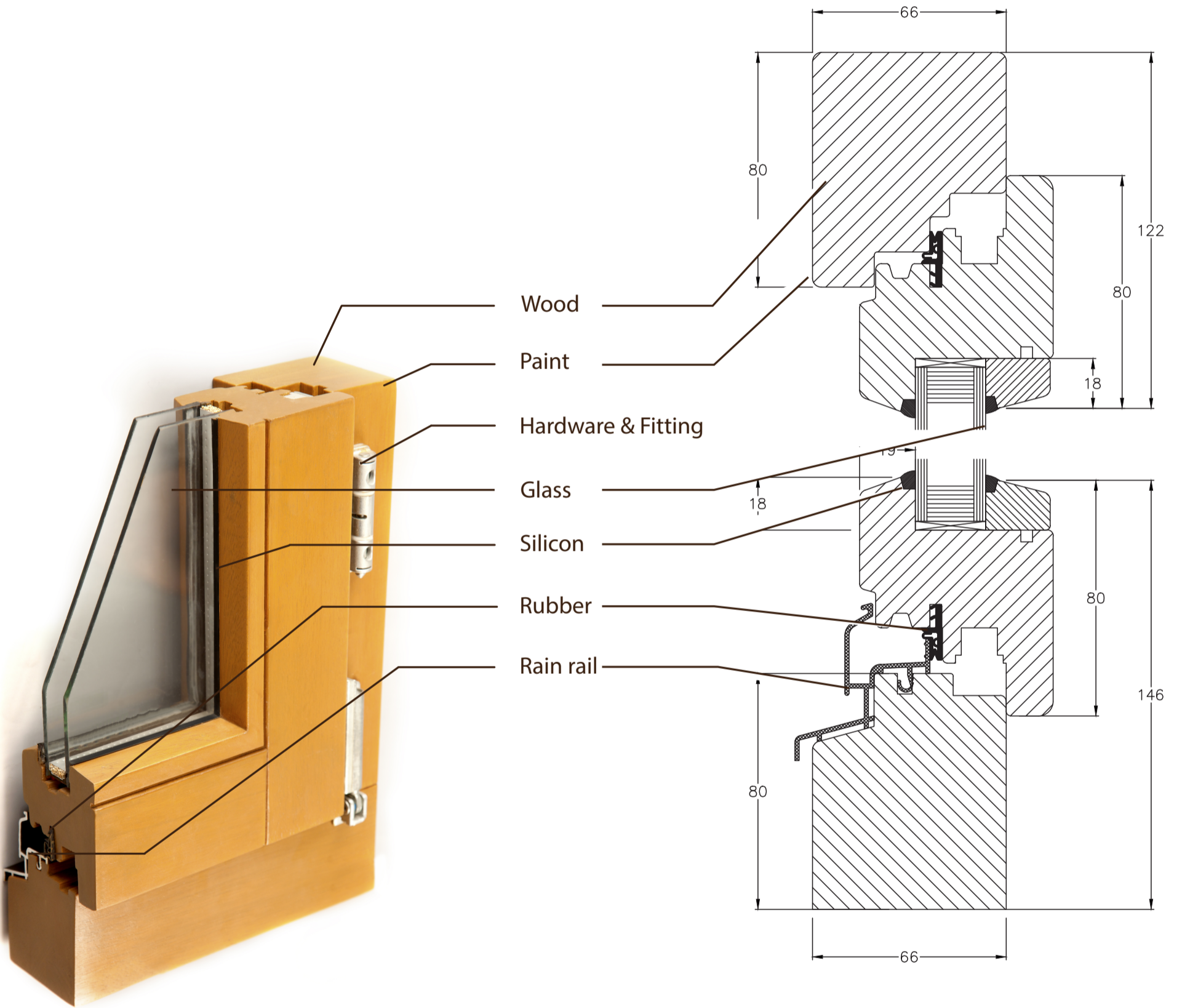

OPENING SOLUTIONS

A. Tilt-Turn System

1. Turn System

		Width (mm)	Height (mm)
Single leaf windows	Min	450	450
	Max	1150	1890
Overlap window	Min	900	500
	Max	2250	1890
Single leaf balcony	Min	450	1900
	Max	1100	2500
Overlap balcony	Min	900	1900
	Max	2150	2500
Fixed (double glass)	Min	400	400
	Max	2500	3000
Fixed (single glass)	Min	400	400
	Max	2500	5000

2. Tilt System

		Width (mm)	Height (mm)
Single leaf windows	Min	450	450
	Max	2400	1200

2. Tilt Slide System

		Width (mm)	Height (mm)
Single leaf windows/ balcony	Min	750	1000
	Max	1500	2500
Overlap window/ balcony	Min	1500	1000
	Max	3000	2500

3. Folding System

The minimum number of leafs is **3 leafs** and the maximum number of leafs is **6 leafs**

		Width (mm)	Height (mm)
Single Leaf	Min	450	1900
	Max	900	2500

4. Lift & Slide System

		Width (mm)	Height (mm)
Single leaf windows/ balcony	Min	1470	1300
	Max	6700	2500
	Max	5800	2800

TILT & TURN HARDWARE

E5/E20/A

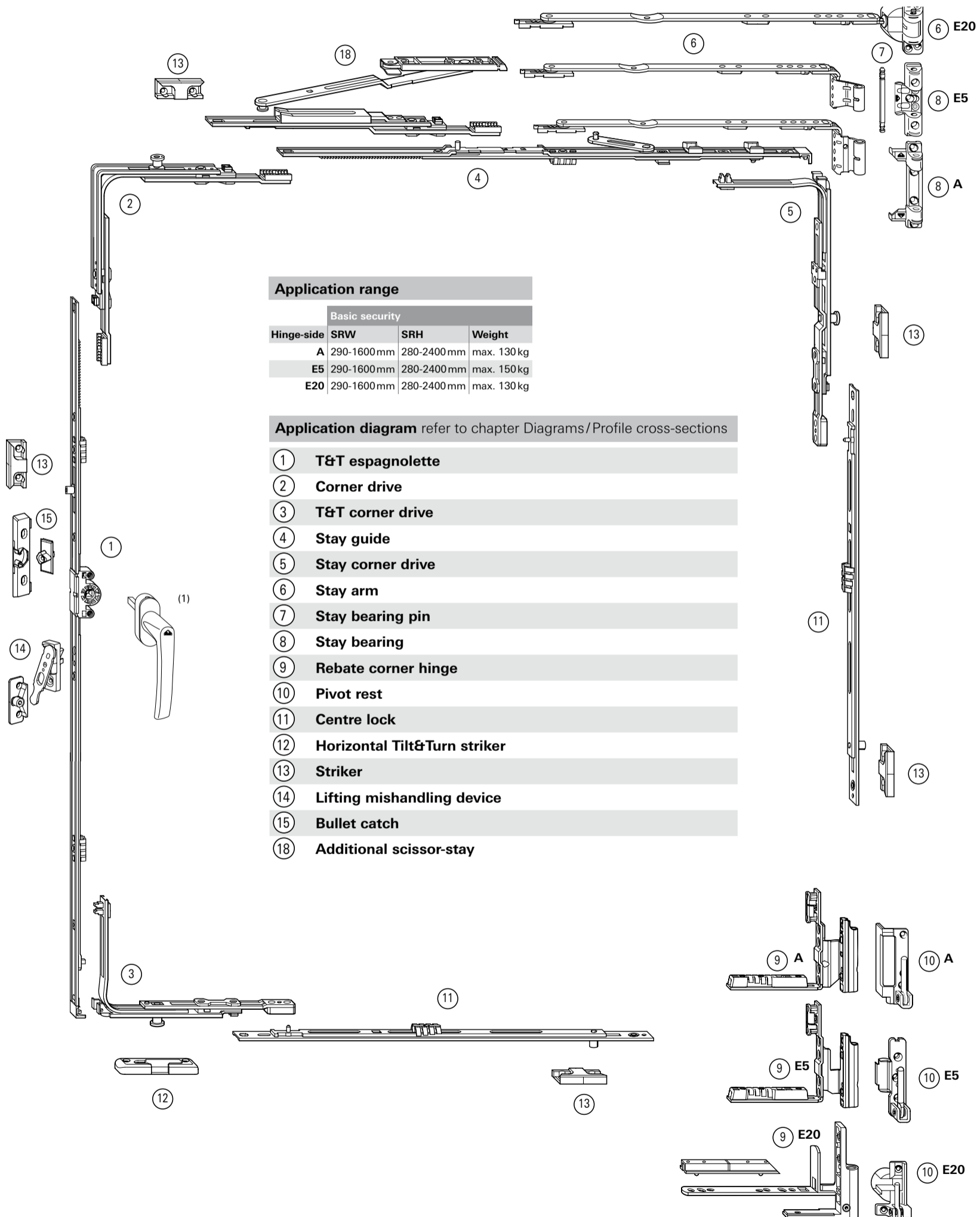
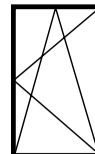

Application range

Basic security			
Hinge-side	SRW	SRH	Weight
A	290-1600mm	280-2400mm	max. 130 kg
E5	290-1600mm	280-2400mm	max. 150 kg
E20	290-1600mm	280-2400mm	max. 130 kg

Application diagram refer to chapter Diagrams/Profile cross-sections

- ① T&T espagnolette
- ② Corner drive
- ③ T&T corner drive
- ④ Stay guide
- ⑤ Stay corner drive
- ⑥ Stay arm
- ⑦ Stay bearing pin
- ⑧ Stay bearing
- ⑨ Rebate corner hinge
- ⑩ Pivot rest
- ⑪ Centre lock
- ⑫ Horizontal Tilt&Turn striker
- ⑬ Striker
- ⑭ Lifting mishandling device
- ⑮ Bullet catch
- ⑰ Additional scissor-stay

TILT & TURN MODEL

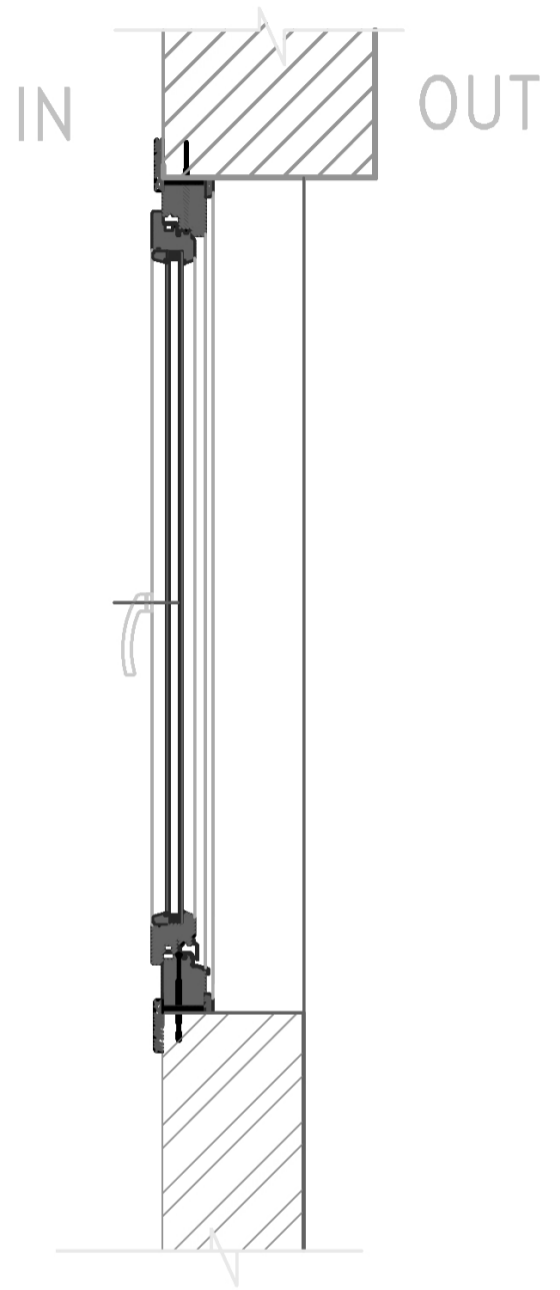
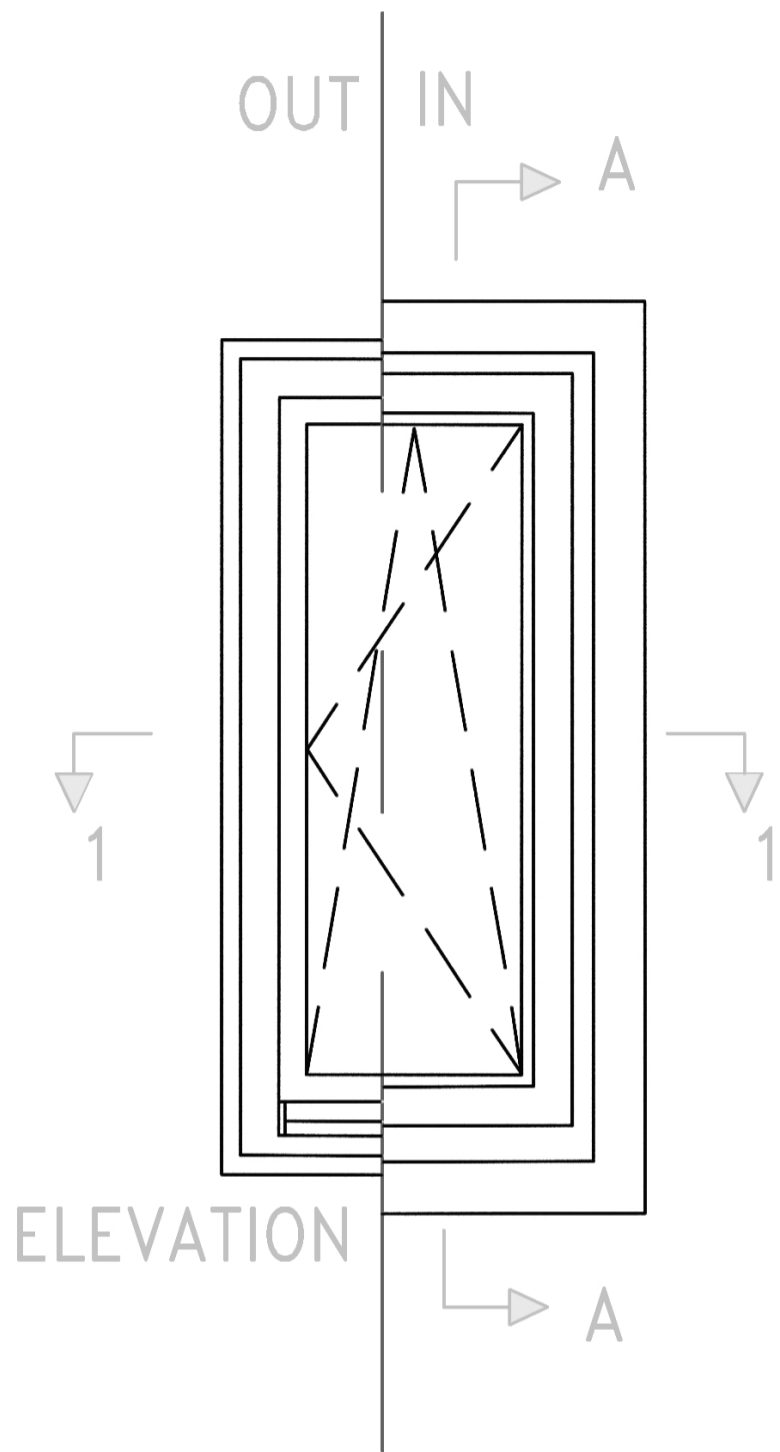

SECTION A-A

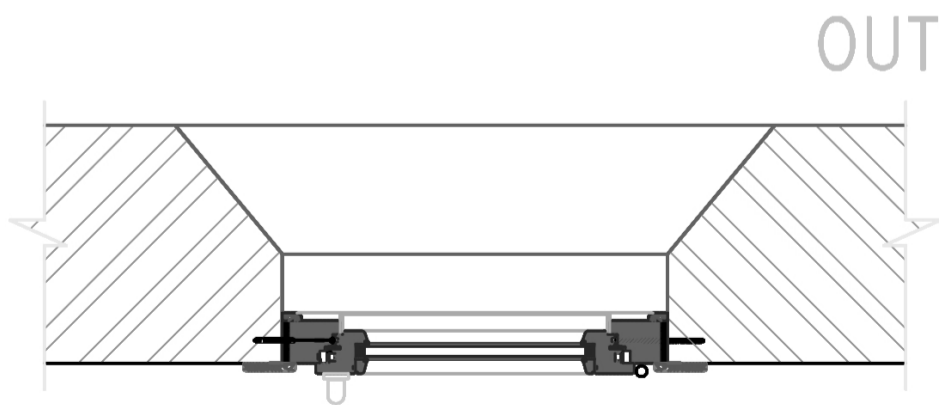

SECTION 1-1

TILT & TURN HARDWARE (OVERLAP)

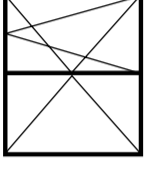

E5/E20/A

Hinge-side E5, systems 12/18(20)-9 and 12/18(20)13
Hinge-side A, systems 12/18(20)-9 and 12/20-13

12mm Clearance
 18/20mm Overlap width
 9/13mm Hardware axis

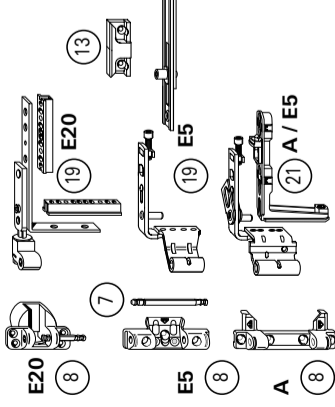

Hinge-side E20, system 4/15-9
 (4-mm frame components not depicted)

4mm Clearance
 15mm Overlap width
 9mm Hardware axis

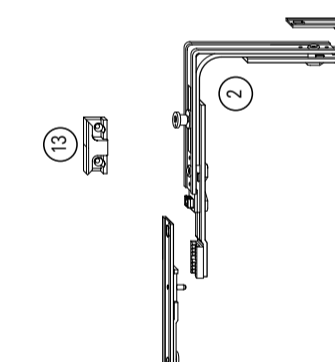

Application range

Basic security			
Hinge-side	SRW	SRH	Weight
A	290-1600mm	431-2400mm	max. 130kg
E5	290-1600mm	431-2400mm	and/or 150kg
E20	290-1600mm	431-2400mm	max. 130kg

Application diagram refer to chapter Diagrams / Profile cross-sections

- 1 T&T espagnolette
- 2 Corner drive
- 3 T&T corner drive
- 4 Stay guide
- 5 Stay corner drive
- 6 Stay arm
- 7 Stay bearing pin
- 8 Stay bearing

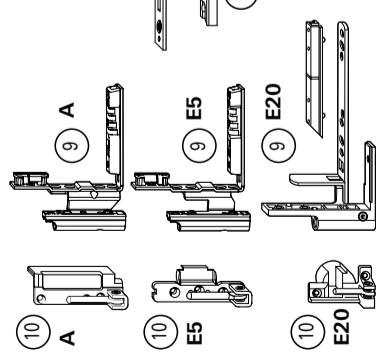

Application diagram refer to chapter Diagrams / Profile cross-sections

- 9 Rebate corner hinge
- 10 Pivot rest
- 11 Centre lock
- 12 Horizontal Tilt&Turn striker
- 13 Striker
- 13 SEC striker
- 14 Lifting mishandling device
- 15 Bullet catch
- 16 Lever-operated espagnolette
- 18 Additional scissor-stay
- 19 (Comfort) rebate hinge
- 21 Comfort sash-component for rebate hinge
- 30 Run-up block
- 38 Concealed centre-closer

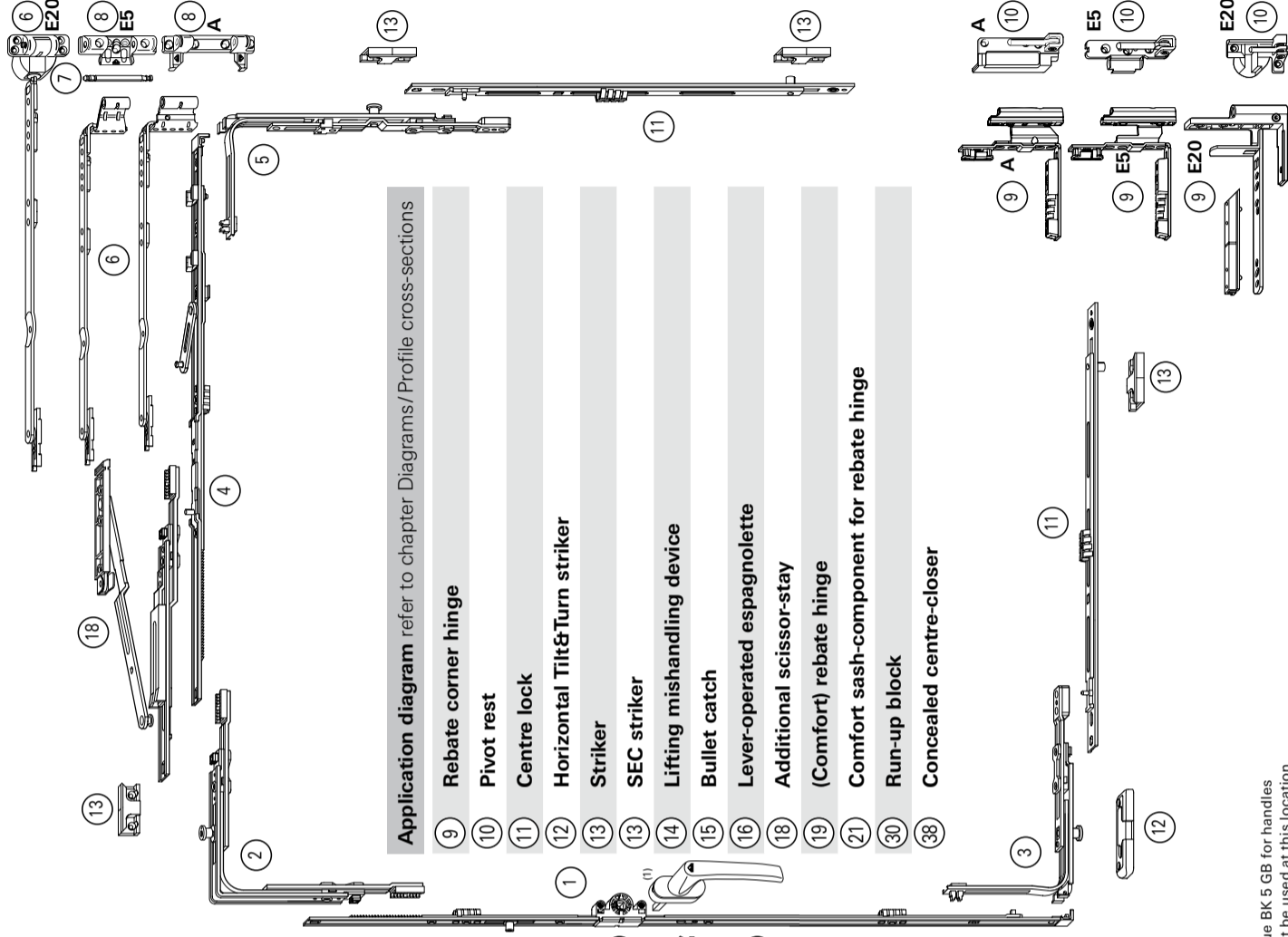

⁽¹⁾ Refer to Roto catalogue BK 5 GB for handles
⁽²⁾ A security striker must be used at this location.

TILT & TURN OVERLAP MODEL

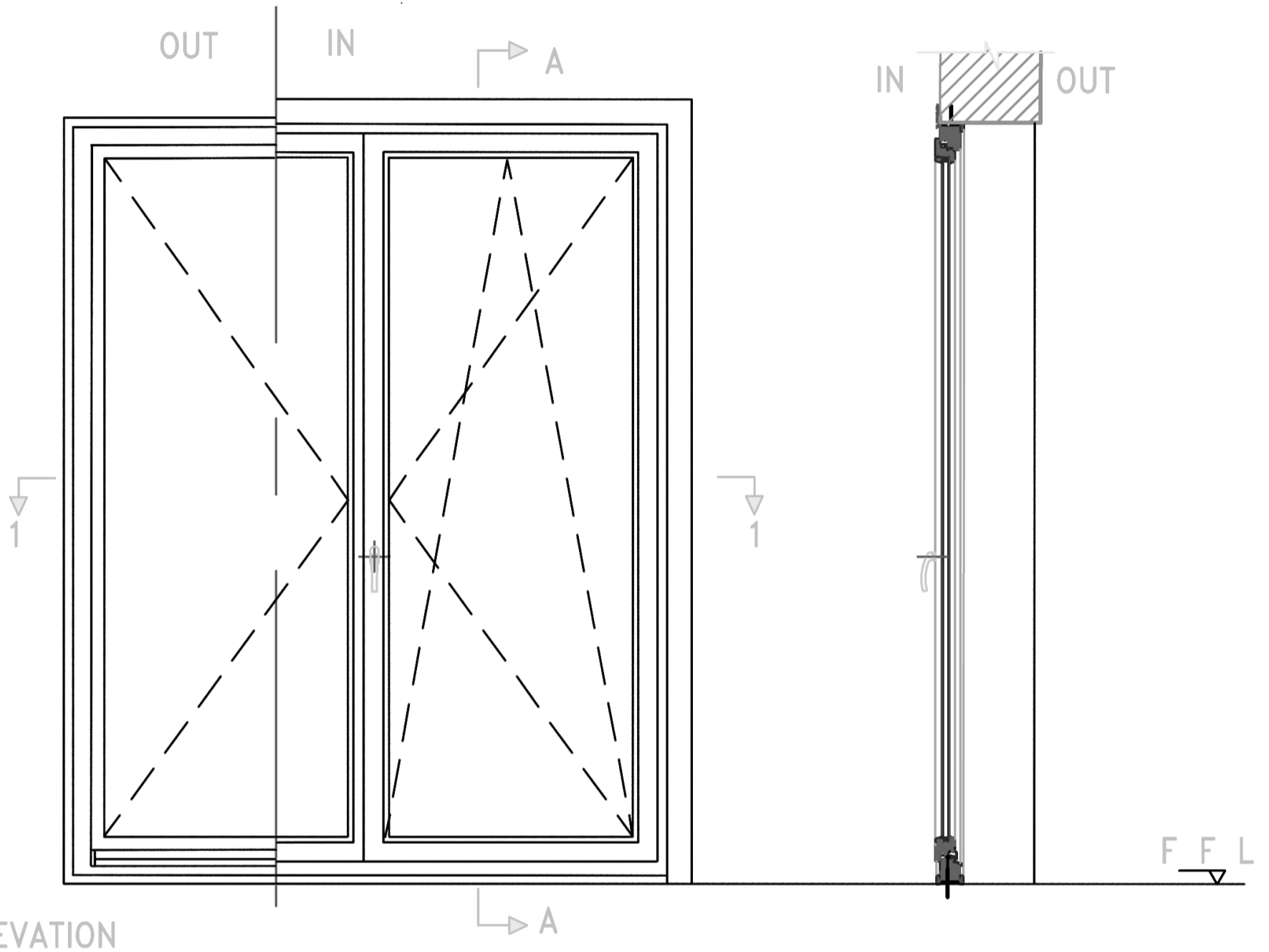

ELEVATION

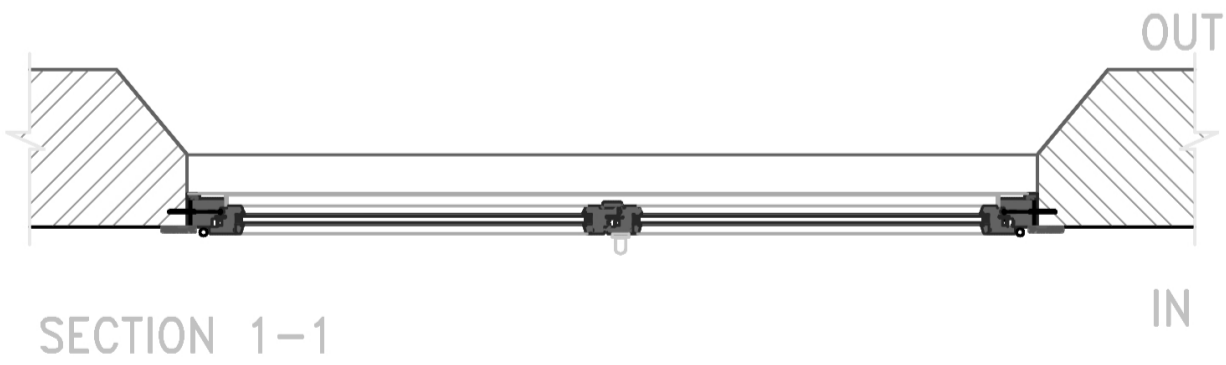

SECTION 1-1

TURN ONLY HARDWARE (SINGLE)

E5/E20/A

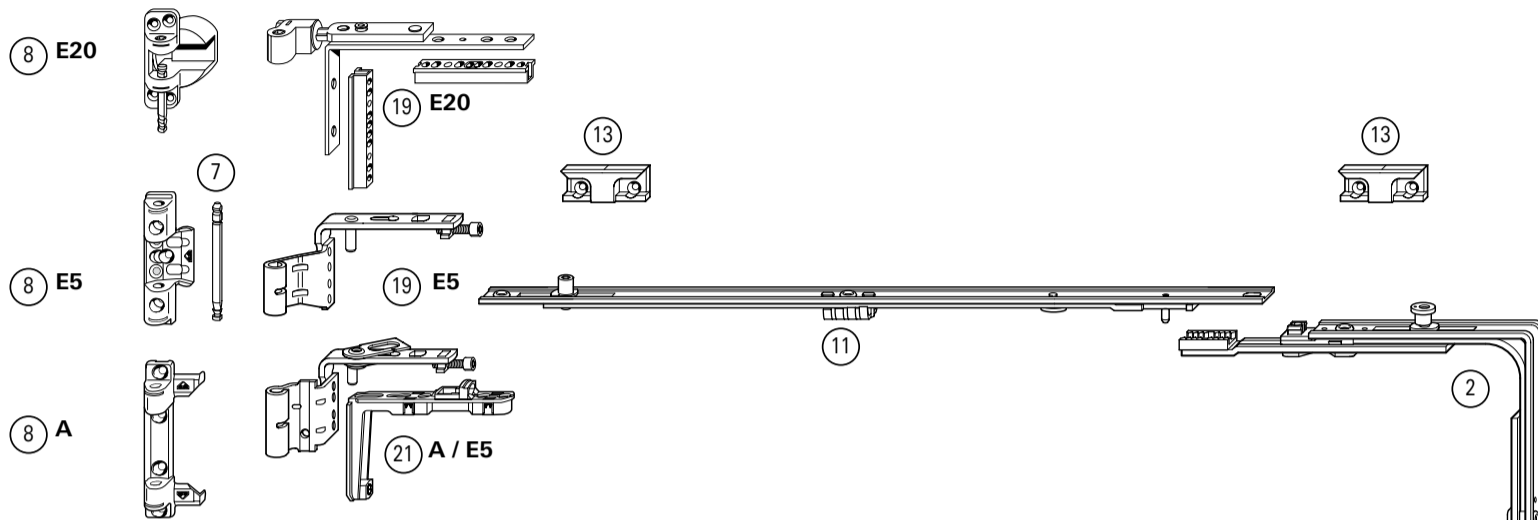
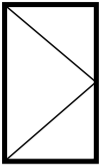

Application range

Hinge-side	Basic security		
	SRW	SRH	Weight
A	290-1600 mm	280-2400 mm	max. 130 kg
E5	290-1600 mm	280-2400 mm	max. 150 kg
E20	290-1600 mm	280-2400 mm	max. 130 kg

Application diagram refer to chapter Diagrams/Profile cross-sections

- ① T&T espagnolette
- ② Corner drive
- ③ T&T corner drive
- ⑦ Stay bearing pin
- ⑧ Stay bearing
- ⑨ Rebate corner hinge
- ⑩ Pivot rest
- ⑪ Centre lock
- ⑬ Striker
- ⑬ SEC striker
- ⑭ Lifting mishandling device
- ⑮ Bullet catch
- ⑲ (Comfort) rebate hinge
- ⑳ Comfort sash-component for rebate hinge
- ㉔ Travel-restrictor
- ㉘ Concealed centre-closer

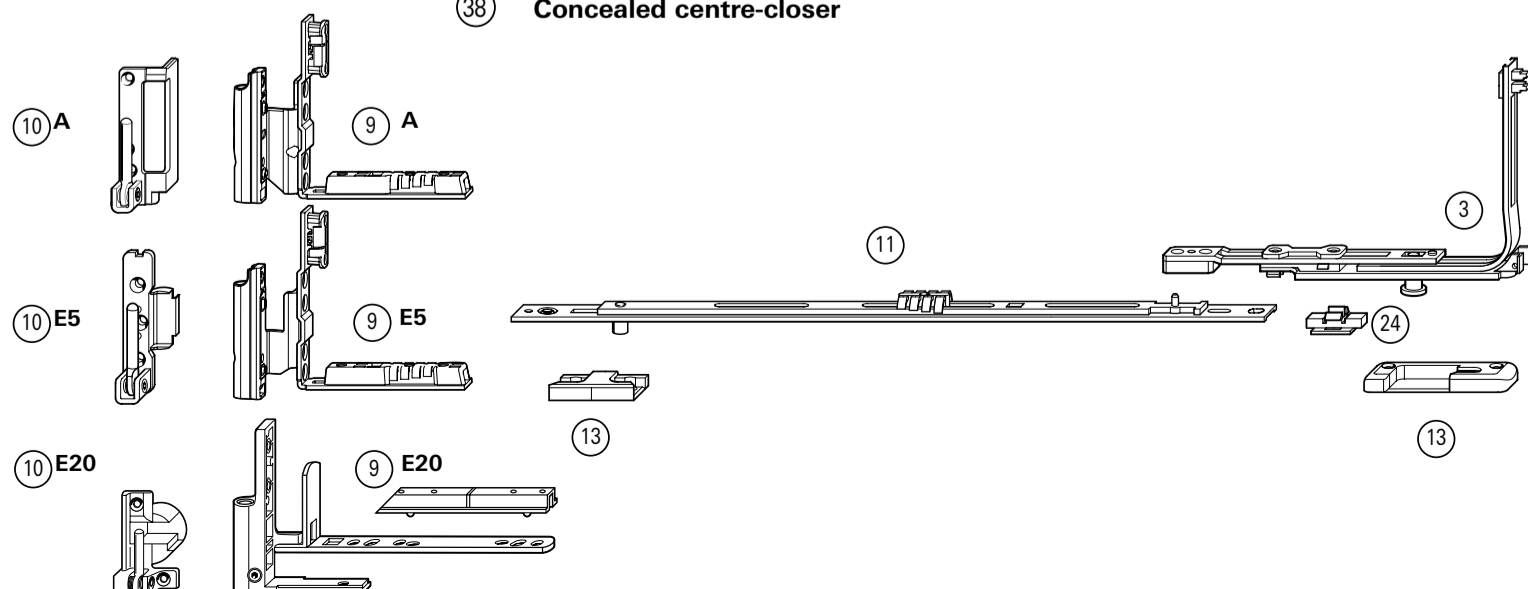
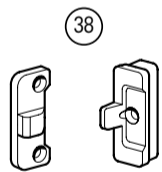

TILT & TURN HARDWARE E5/E20 FOR ARCHED WINDOWS

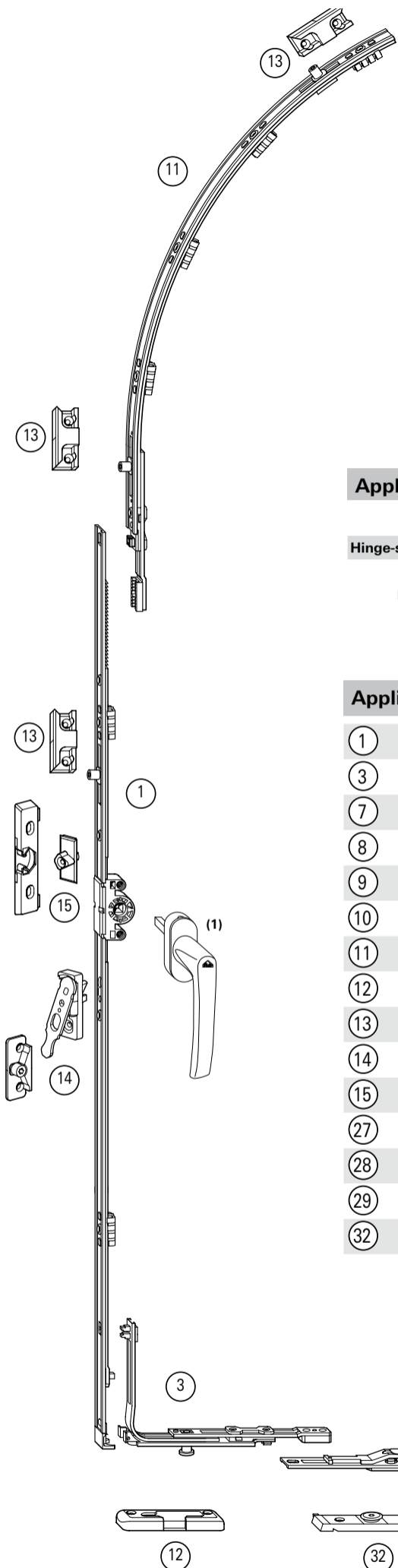
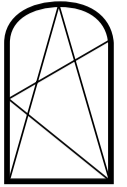

Application range			
Basic security			
Hinge-side	SRW	SRH	Weight
E5	400-1300 mm	500-1900 mm	max. 80 kg
E20	400-1300 mm	500-1900 mm	max. 80 kg

Application diagram refer to chapter Diagrams/Profile cross-sections

- ① T&T espagnolette
- ③ T&T corner drive
- ⑦ Stay bearing pin
- ⑧ Stay bearing
- ⑨ Rebate corner hinge
- ⑩ Pivot rest
- ⑪ Arched centre lock
- ⑫ Horizontal Tilt&Turn striker
- ⑬ Striker
- ⑭ Lifting mishandling device
- ⑮ Bullet catch
- ⑰ Arched corner drive
- ⑱ Horizontal arched component
- ⑲ Arched component
- ⑳ Arched stay arm, basic set

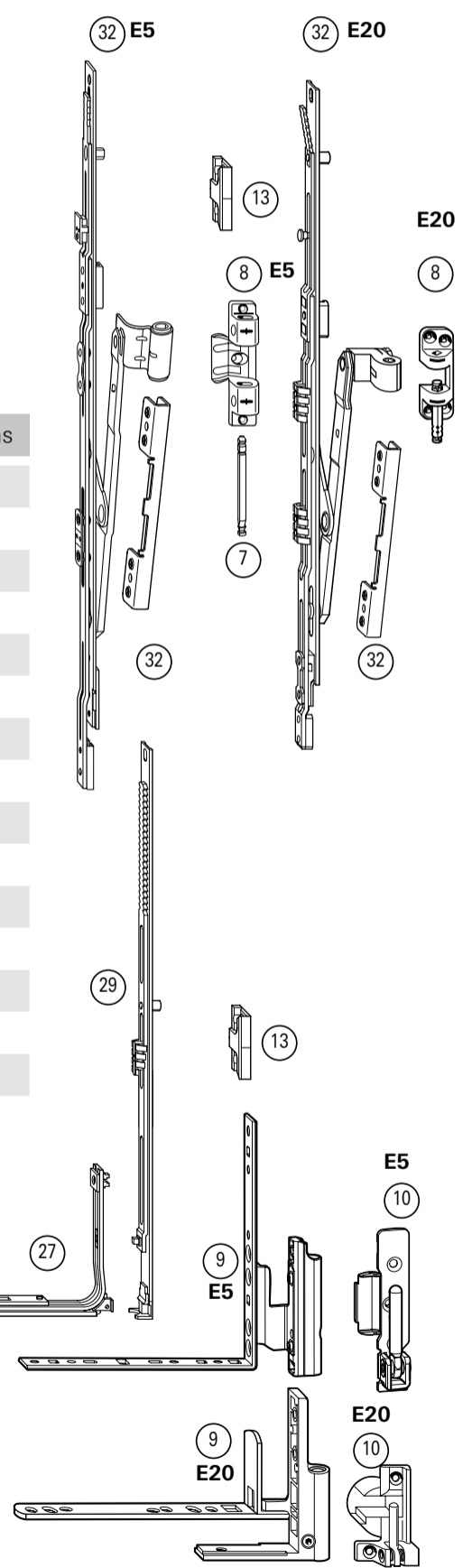

TILT ONLY HARDWARE

E5/A

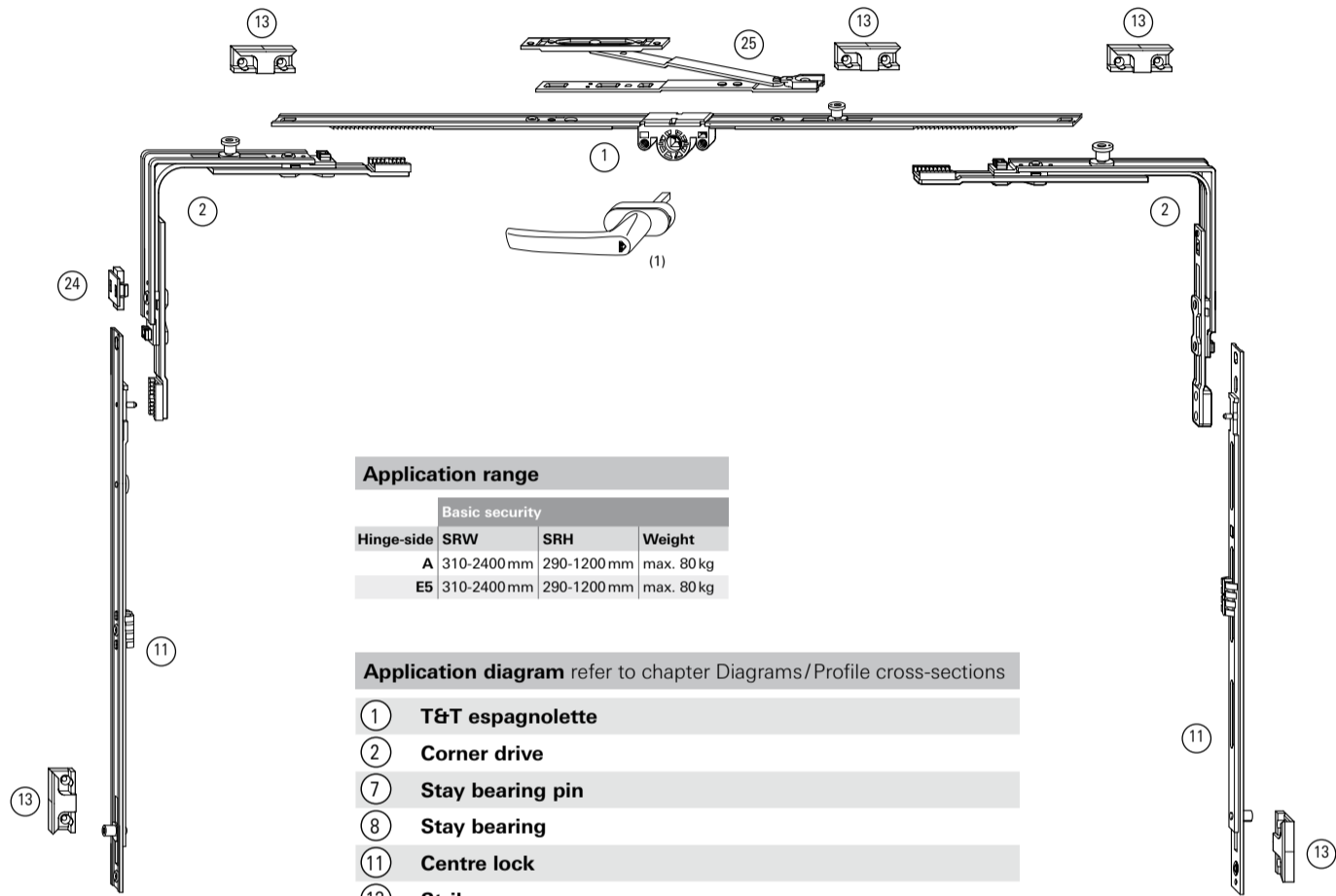
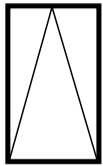

Application range

Basic security			
Hinge-side	SRW	SRH	Weight
A	310-2400 mm	290-1200 mm	max. 80 kg
E5	310-2400 mm	290-1200 mm	max. 80 kg

Application diagram refer to chapter Diagrams / Profile cross-sections

- ① T&T espagnolette
- ② Corner drive
- ⑦ Stay bearing pin
- ⑧ Stay bearing
- ⑪ Centre lock
- ⑬ Striker
- ⑳ Turn-Only rebate hinge
- ㉔ Travel-restrictor
- ㉕ Tilt-stay

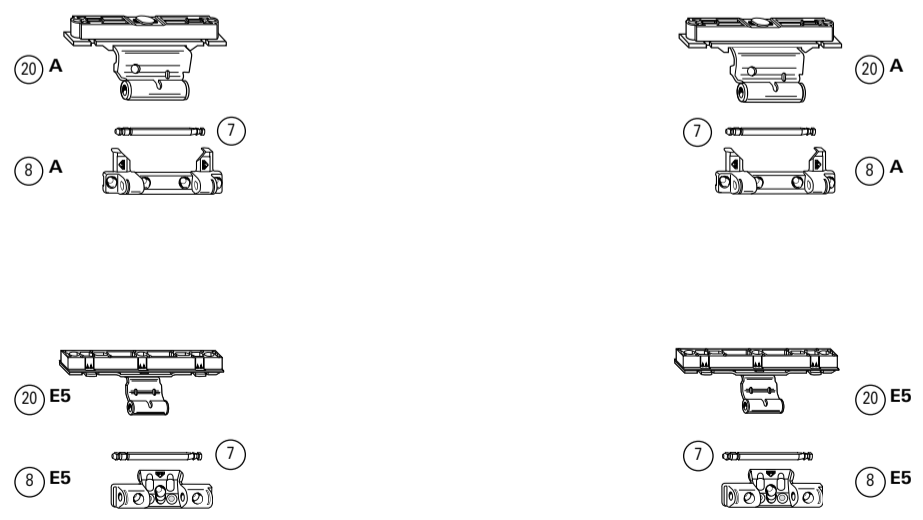

TILT & SLIDE HARDWARE

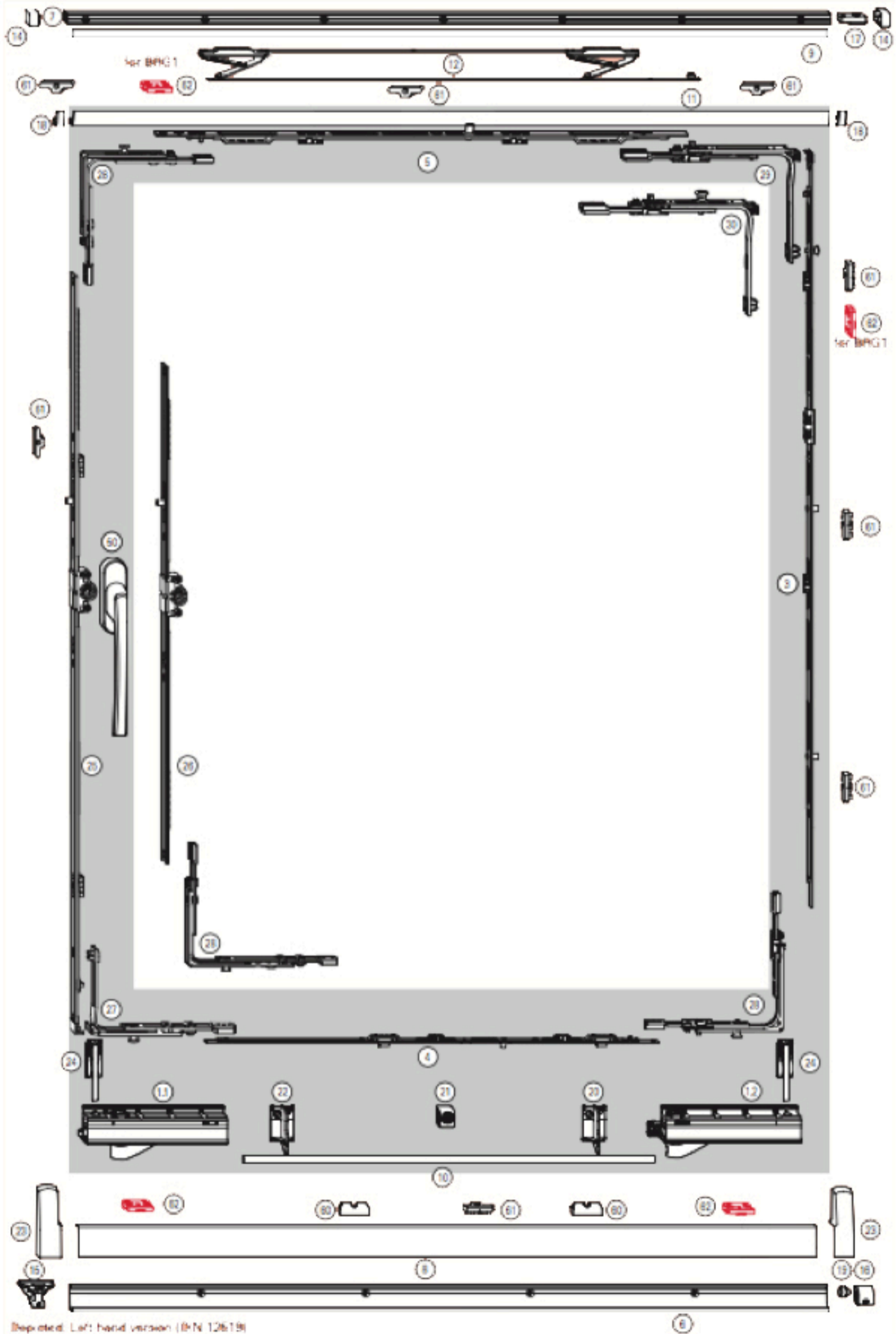

TILT & SLIDE MODEL

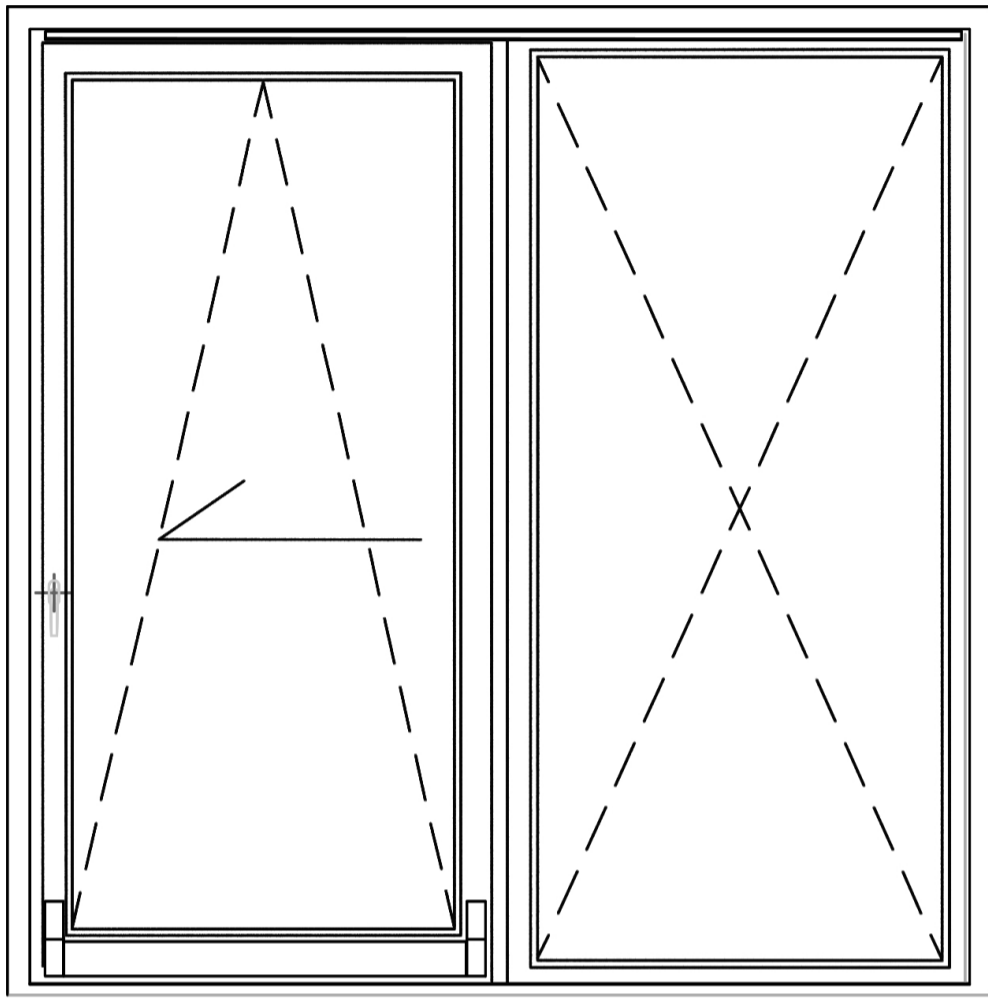

→ A

OUT

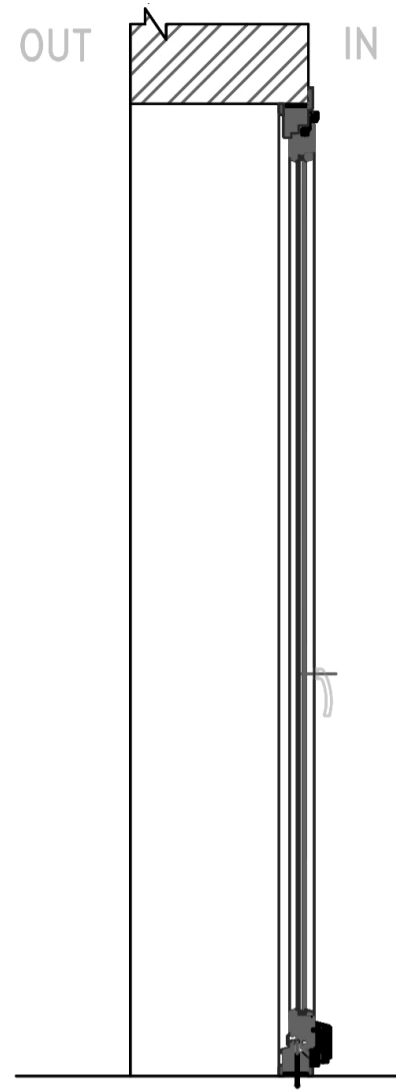

SECTION A-A

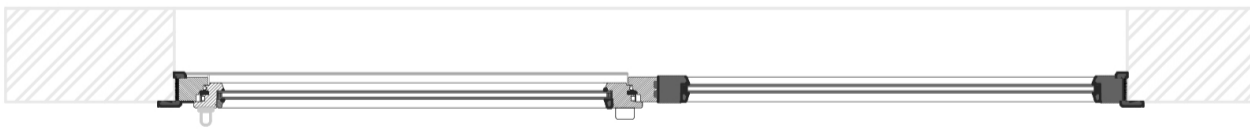

LIFT & SLIDE HARDWARE

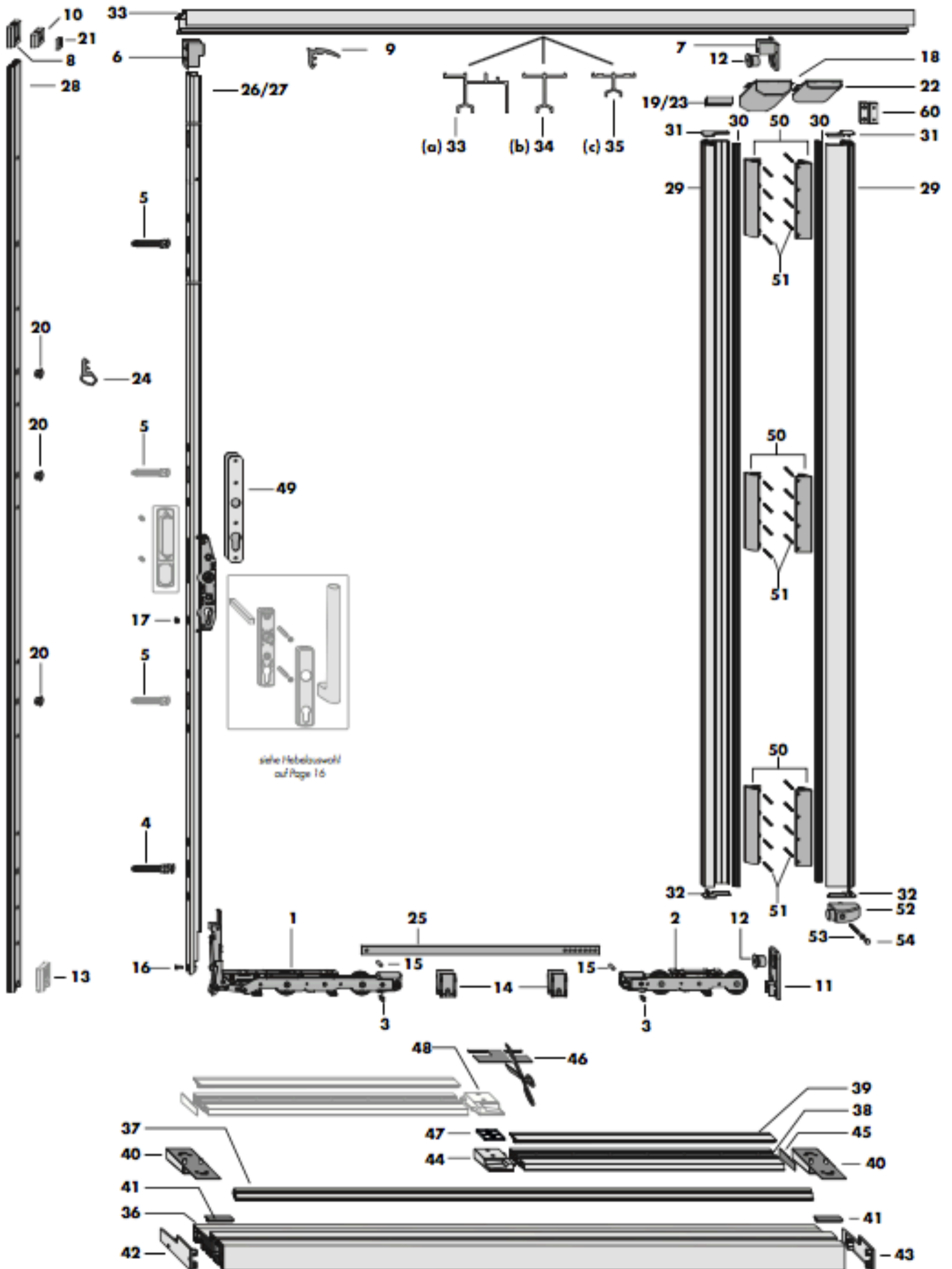

Item	Quantity scheme			PORTAL HS 300 scheme A		Material number	
	A (a)	A (b)	A (c)	Description	RAL 7040 grey	RAL 9005 black	
	1	1	1	Handle Si-line PORTAL HS 300		See handle selection on page 16	
	1	1	1	Basic carton HS 300 TS consisting of:		PMKB0300-10001_	
1	1	1	1	Bogie wheels V	VSU HS 300 TS		
2	1	1	1	Bogie wheels H	HS 300 TS		
3	1	1	1	Brush	Length 100 mm		
	1	1	-	Carton HS-H HH0130-02/-03 consisting of:		PMZB0330-0E601_	PMZB0330-02301_
4	1	1	-	Locking bolt E, bottom TS			
5	1	1	-	Locking bolt E, top TS			
6	1	1	-	Front top guide			
7	1	1	-	Rear top guide			
8	1	1	-	Top filling piece	for guide rail HH0130-02/-03		
9	1	1	-	Top seal HH0134-01	Length 10.2 m		
	-	-	1	Carton HS-H HH0130-04 consisting of:		PMZB0340-0E601_	PMZB0340-02301_
4	-	-	1	Locking bolt E, bottom TS			
5	-	-	1	Locking bolt E, top TS			
6	-	-	1	Front top guide			
7	-	-	1	Rear top guide			
10	-	-	1	Top filling piece	for guide rail HH0130-04		
9	-	-	1	Top seal HH0134-01	Length 10.2 m		
	1	1	1	Bag of accessories HS-H bottom high consisting of:		PMZB0310-0E601_	PMZB0310-02301_
11	1	1	1	Bottom cover plate rear high			
12	2	2	2	STOP			
13	0..1	0..1	0..1	Bottom high filling piece	for sealing rail B made of timber		
14	2	2	2	Bottom guide			
15	2	2	2	Dowel pin 6 x 16			
16	1	1	1	M5 x 13 countersunk screw			
17	1	1	1	Closing cap	grey		
				Closing cap	brown		
	1	1	-	Sealing parts set HS-H HH0130-02/03 IV 68 consisting of:		PMZB0370-0E601_	PMZB0370-02301_
18	1	1	-	Sealing bridge size 2			
19	1	1	-	Top sealing part			
20	3	3	-	Closing cap	For sealing rail B		
21	1	1	1	Top sealing part HSK			
	-	-	1	Sealing parts set HS-H HH0130-04 IV 68 consisting of:		PMZB0400-0E601_	PMZB0400-02301_
22	-	-	1	Sealing bridge A0017			
23	-	-	1	Top sealing part			
20	-	-	3	Closing cap	For sealing rail B		
21	1	1	1	Top sealing part HSK			
24	1	1	1	Seal HH0134-02	Length 17.5 m	RAL 7040 grey PDPB0030-0E601_	RAL 9005 black PDPB0030-09901_
depending on FB				Connecting rod	Size length (in mm) FB (in mm)		
25	1	1	1		150 TS 898 720 to 1500	719282	
					200 TS 1398 1501 to 2000	719480	
					250 TS 1898 2001 to 2500	719497	
					335 TS 2748 2501 to 3350	719725	
depending on sash height				Gear PORTAL HS 300 PZ or lift and slide sash up to 200 kg	Size Handle height (mm) Sash height (mm)	EV 1 silver	
26	1	1	1		170 410 1208 to 1775	PGKB0010-52401_	
					220 1010 1776 to 2275	PGKB0020-52401_	
					260 1010 2276 to 2675	PGKB0030-52401_	
27				Comfort gear PORTAL HS 300 PZ for lift and slide sash from 200 kg	Size Handle height (mm) Sash height (mm)	EV 1 silver	
					220 1010 1776 to 2275	PGKB4070-52401_	
					260 1010 2276 to 2675	PGKB4080-52401_	
28	1	1	1	Sealing rail B Alternative: rail B in timber version	Size FH (in mm)	RAL 7040 grey PPDB0010-0E601_	RAL 9005 black PPDB0010-02301_
					260 1208 to 2675		
	1	1	1	Sealing rail C Alternative: rail C in timber version	Size sash clearance (in mm) FH (in mm)	RAL 7035 grey PMZB0180-02101_	
					260 28 1208 to 2675		
29	2	2	2	Sealing rail C HS	Length 2.7 m		
30	2	2	2	Sealing profile rail C HS	for sealing rail C		
31	2	2	2	Cover cap left sealing rail C			
32	2	2	2	Cover cap right sealing rail C			

A (a) = Element with guide rail HH 0130-02 

A (b) = Element with guide rail HH 0130-03 

A (c) = Element with guide rail HH 0130-04 

LIFT & SLIDE MODEL

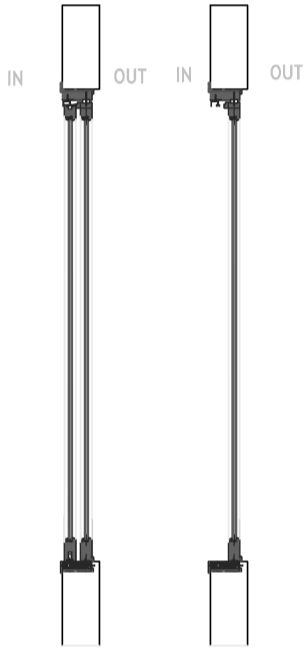
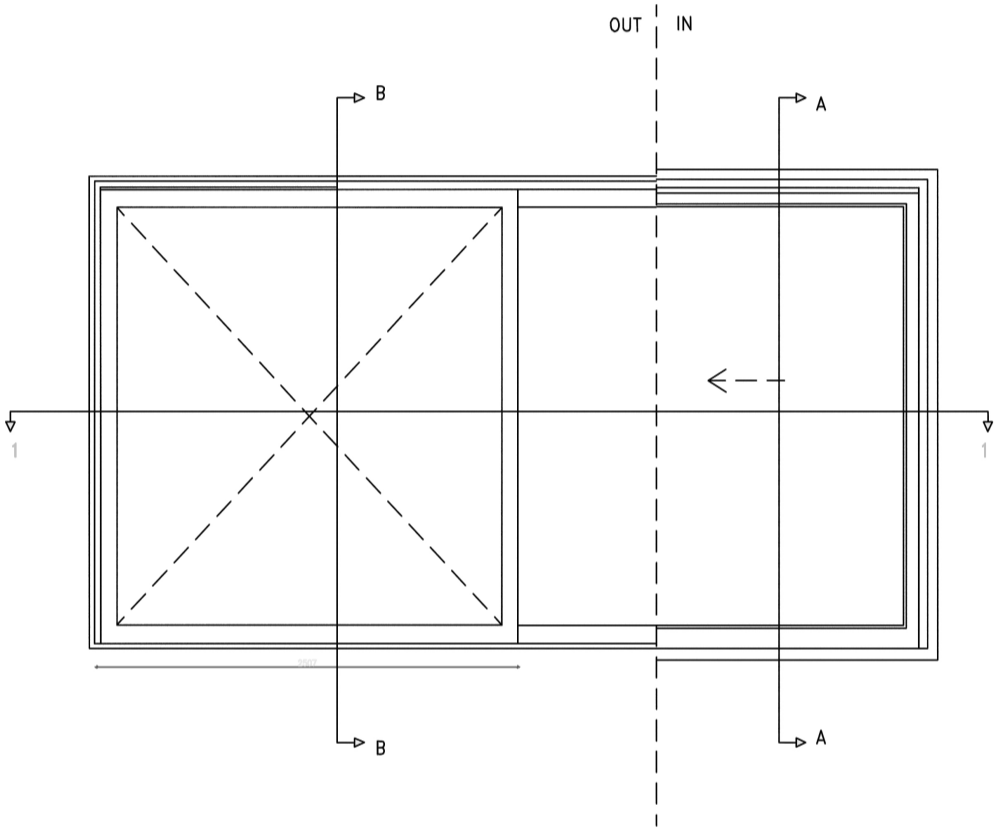

SECTION A-A

SECTION B-B

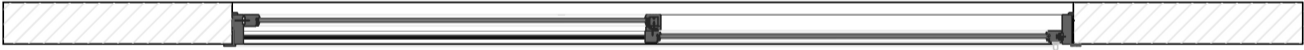

SECTION 1-1

FOLDING MODEL

